

DESIGN NOTES DEEP HOLE MEASUREMENT

To design the Anvil head for Deep Hole measurement, the following information is required:

How to understand

- ED** : Smallest dia through which the given head has to pass
- L** : Length at which measurement is req. (Add extension if required)
- DC** : Depth of clearance for Cover plate (If there is no Bottom or Head clearance, extra special Anvil Design can be provided)

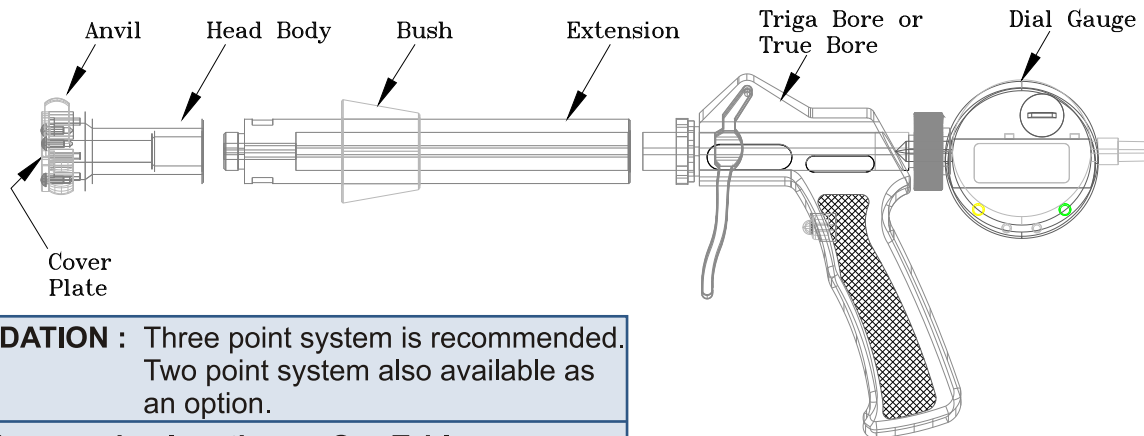
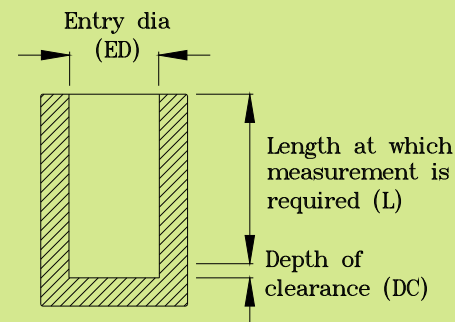

RECOMMENDATION : Three point system is recommended. Two point system also available as an option.

For standard measuring lengths : See Table

More than one extension can be used. For extension lengths available : See Table

The purpose of the Bush is to protect the Anvils when sliding through deep holes. For normal applications this bush is not required. When measuring deep holes user should ensure the alignment of Gauge axis and

Bore axis. For measuring deep holes Spherical contact points are preferred because they allow certain amount of deviation in Gauge axis without affecting accuracy.

For measuring less deep holes, standard contact points can be used.

CONTACT POINTS AVAILABLE



Spherical contact point

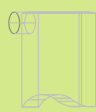

Blind bore contact point

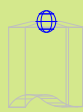

Ball contact point

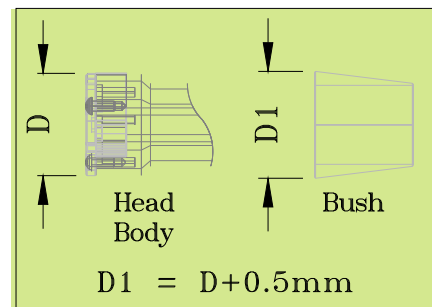

Please fill in the following information for Quotations:

Contact Name :
Company :
Country :
E-mail :
URL :
Tel. No. :
Fax No. :

Parameter	Size	
	mm	inch
ED		
L		
DC		